

BRIDGE INSPECTOR'S RECOMMENDATION FOR MAINTENANCE REPAIRS

Bridge: 750205

County RANDOLPH

Date:

These Repairs Should Be Made Within Twelve Months From Date Of This Inspection

| MMS Code | Description of Function | Unit | Quantity | Remarks | Est. Cost |
|--|--|------|----------|--|-----------|
|  3314 | Maintain Steel Superstructure Components | LF | 30 | INITIAL POINT OF IMPACT (POI) AT 17'-6" FROM BENT 4 BEARING. BEAM OUT OF PLUMB 9" TO THE NORTH AT POI - TOTAL OF 30LF OF BEAM DEFLECTED FROM INT. DIAPHRAGM #1 IN BAY 4 TO BENT 4 BEARING. --- 7"L x 2-3/4"W TEAR IN SOUTH HALF OF BOTTOM FLANGE AT POI - 9" OF BOTTOM FLANGE REMAINING. --- OUTSIDE EDGE OF BOTTOM FLANGE SCRAPED AND GOUGED UP TO 1/4"D ACROSS 11"L SECTION ADJACENT TO POI. --- 17"H x 36"W x 3"D DEFORMATION IN WEB AT POI, BEGINNING 3" FROM TOP FLANGE. --- BOTTOM HALF OF DIAPHRAGM #2 BENT TO THE WEST APPROX. 8" AT BEAM 5 CONNECTION, w/ DAMAGE TO ENTIRE LENGTH OF DIAPHRAGM CONNECTION BRACKET - MAX DEFLECTION OF 6" TO THE WEST. | |

Key

 Priority Maintenance Item

 Critical Finding Item

 Priority Maintenance Level Not Determined

BRIDGE INSPECTOR'S RECOMMENDATION FOR PRIORITY MAINTENANCE REPAIRS

Bridge: 750205

County RANDOLPH

THE FOLLOWING MAINTENANCE ITEMS HAVE BEEN SUBMITTED IN CONJUNCTION WITH A PRIORITY MAINTENANCE REQUEST

| MMS Code | MMS Description | Quantity |
|---|--|--------------|
| 3314 | Maintain Steel Superstructure Components | 30 LF |
| Location: | | |
| Bent/Span No. | | |
| Priority Level | Status | |
| | Request Awaiting Assignment | |
| Submitted Date: | Submitted By: | Assisted By: |
| 07/13/2017 | J. WHITE | |
| Details | | |
| <p>INITIAL POINT OF IMPACT (POI) AT 17'-6" FROM BENT 4 BEARING. BEAM OUT OF PLUMB 9" TO THE NORTH AT POI - TOTAL OF 30LF OF BEAM DEFLECTED FROM INT. DIAPHRAGM #1 IN BAY 4 TO BENT 4 BEARING. --- 7"L x 2-3/4"W TEAR IN SOUTH HALF OF BOTTOM FLANGE AT POI - 9" OF BOTTOM FLANGE REMAINING. --- OUTSIDE EDGE OF BOTTOM FLANGE SCRAPED AND GOUGED UP TO 1/4"D ACROSS 11"L SECTION ADJACENT TO POI. --- 17"H x 36"W x 3"D DEFORMATION IN WEB AT POI, BEGINNING 3" FROM TOP FLANGE. --- BOTTOM HALF OF DIAPHRAGM #2 BENT TO THE WEST APPROX. 8" AT BEAM 5 CONNECTION, w/ DAMAGE TO ENTIRE LENGTH OF DIAPHRAGM CONNECTION BRACKET - MAX DEFLECTION OF 6" TO THE WEST.</p> | | |

Structure Data Worksheet

Spans

County: RANDOLPH Structure No: 750205 Date: _____ Inspected By: JRW

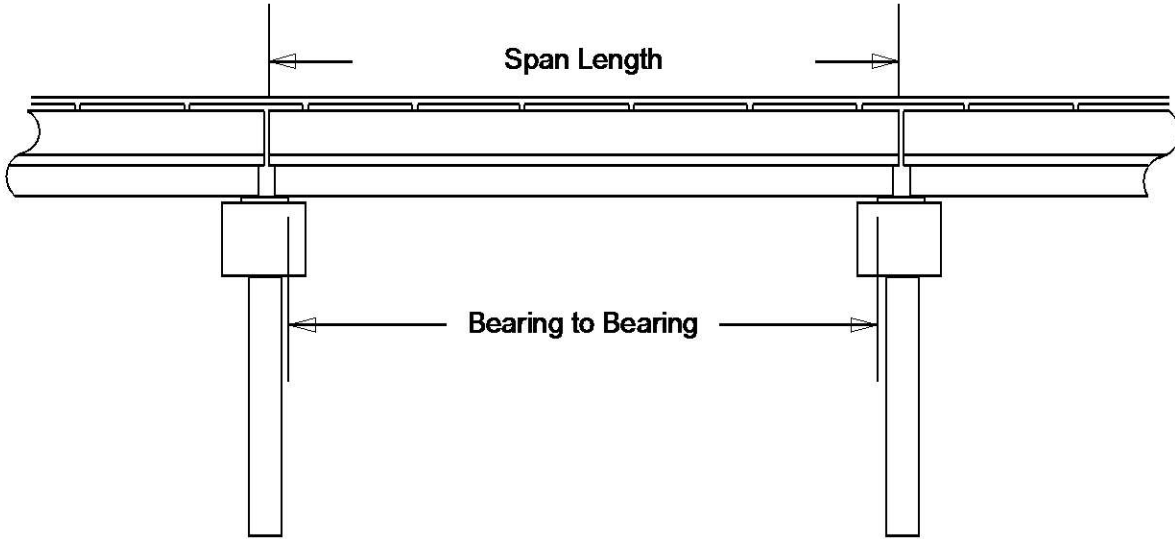

| Span No | Span Length | Bearing to Bearing | Comments |
|---------|-------------|--------------------|------------------------------|
| 1 | 43.0' | 41.42' | NBIS BRIDGE LENGTH = 231'-0" |
| 2 | 43.0' | 42.0' | |
| 3 | 54.0' | 53.0' | |
| 4 | 54.0' | 53.0' | |
| 5 | 43.0' | 41.42' | |

Bridge Inspection Field Sketch



MEASURED 25' FROM EBT 1

| | | | |
|-----------------|-----------------|---------------|--------------|
| Roadway | 22ft Wide | 2 Paved Lanes | Looking East |
| Left Shoulder | 7.5ft Wide | 2.5ft Paved | 5ft Sidewalk |
| Right Shoulder | 8.5ft Wide | 3.5ft Paved | 5ft Sidewalk |
| Left Guardrail | 7.5ft from road | | |
| Right Guardrail | 8.5ft from road | | |

CHANGED ROADWAY WIDTH
CHANGED LEFT & RIGHT SHOULDER
CHANGED LEFT & RIGHT GUARDRAIL

MODIFIED BY HMS 7/8/2015

Title

APPROACH ROADWAY SKETCH

Description

WEST APPROACH LOOKING EAST

Bridge No: 750205

Drawn By: RCL

Date: 07/18/11

File Name: S0066000590

Bridge Inspection Field Sketch

| | | | |
|-------------------------------------|---------|-----------------|----------|
| Deck Width/Out to Out | 40.25ft | Between Rails | 38.25ft |
| Clear Roadway | 28.25ft | Wearing Surface | |
| Median Width | | Median Height | |
| Curb Height | | Left | 0.917ft |
| | | Right | 0.917ft |
| Sidewalk Width | | Left | 5ft |
| | | Right | 5ft |
| Clear Roadway (Rail to Median) | | Left | 14.125ft |
| | | Right | 14.125ft |
| Guardrail Width | | Left | 1ft |
| | | Right | 1ft |
| Top of Rail to Deck/Wearing Surface | | Left | 4.333ft |
| | | Right | 4.333ft |
| Bridge Rail | | Left | Type 27 |
| | | Right | Type 27 |

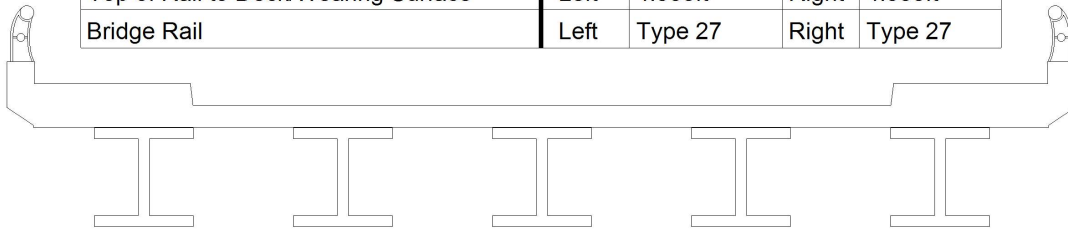

| | | | |
|-------------------------------|-------|----------------|------|
| Measurements for Span # | 1 | | |
| Deck Thickness | .646 | Left Overhang | 5.17 |
| Top of Rail to Bottom of Beam | 7.583 | Right Overhang | 5.08 |

| Beam Number | Beam Type | Spacing | Comments |
|-------------|--------------|---------|----------|
| 1 | Steel I Beam | 7.5ft | |
| 2 | Steel I Beam | 7.5ft | |
| 3 | Steel I Beam | 7.5ft | |
| 4 | Steel I Beam | 7.5ft | |
| 5 | Steel I Beam | | |

NO CURVED GIRDERS

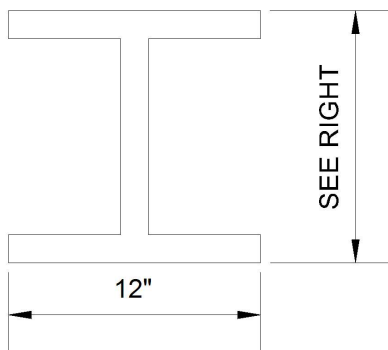

BEAMS: SPANS 1,2, & 5 - W36X135
 SPANS 3 & 4 INT: W33X118
 EXT: W36X135

**BEAMS IN SPANS 1 & 5
 (MEASURED)**

RIGHT OVERHANG CHANGED
 MODIFIED BY HMS 7/8/2015

| | |
|---------------------------------------|------------------------------------|
| Title STRUCTURE DATA SKETCH | Description LOOKING EAST |
| Bridge No: 750205 | Drawn By: RCL |
| Date: 07/24/11 | File Name: S0066000591 |

Bridge Inspection Field Sketch

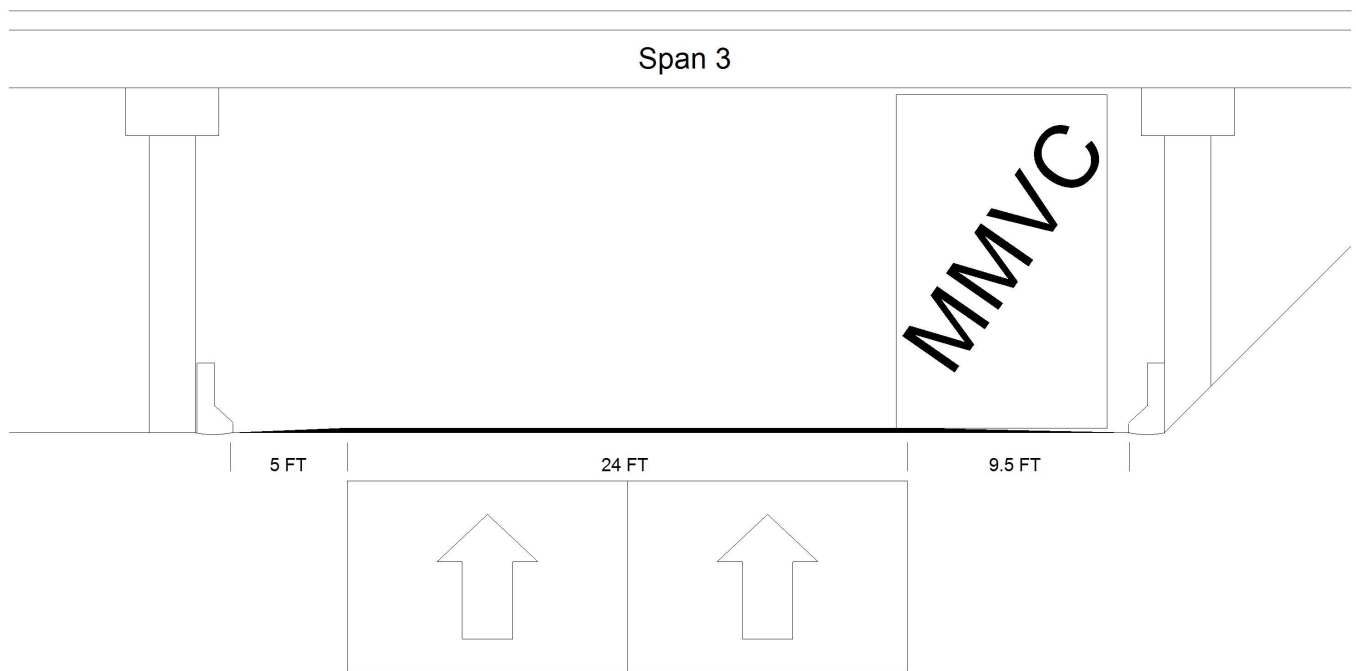

| | | | |
|--------------------------------|---|------------------------|-------|
| Roadway 1 | | Direction of Traffic | South |
| Distance to Left Rail | 5FT | Distance to Right Rail | 9.5FT |
| Distance to Left Toe of Slope | | Distance to Left Bent | 6.5FT |
| Distance to Right Toe of Slope | 11FT | Distance to Right Bent | 11FT |
| MMVC | 17.92 Ft at Beam 5, MEASURED AT 10 FT FROM RIGHT CURB | | |
| MVC | 16.67 Ft at Beam 5, 0 FT from - LEFT CURB | | |

MMVC CHANGED

MODIFIED BY HMS 7/8/2015

Title

UNDER CLEARANCE SPAN 3

Description

LOOKING SOUTH

Bridge No: 750205

Drawn By: RCL

Date: 07/24/11

File Name: S0066000592

Bridge Inspection Field Sketch

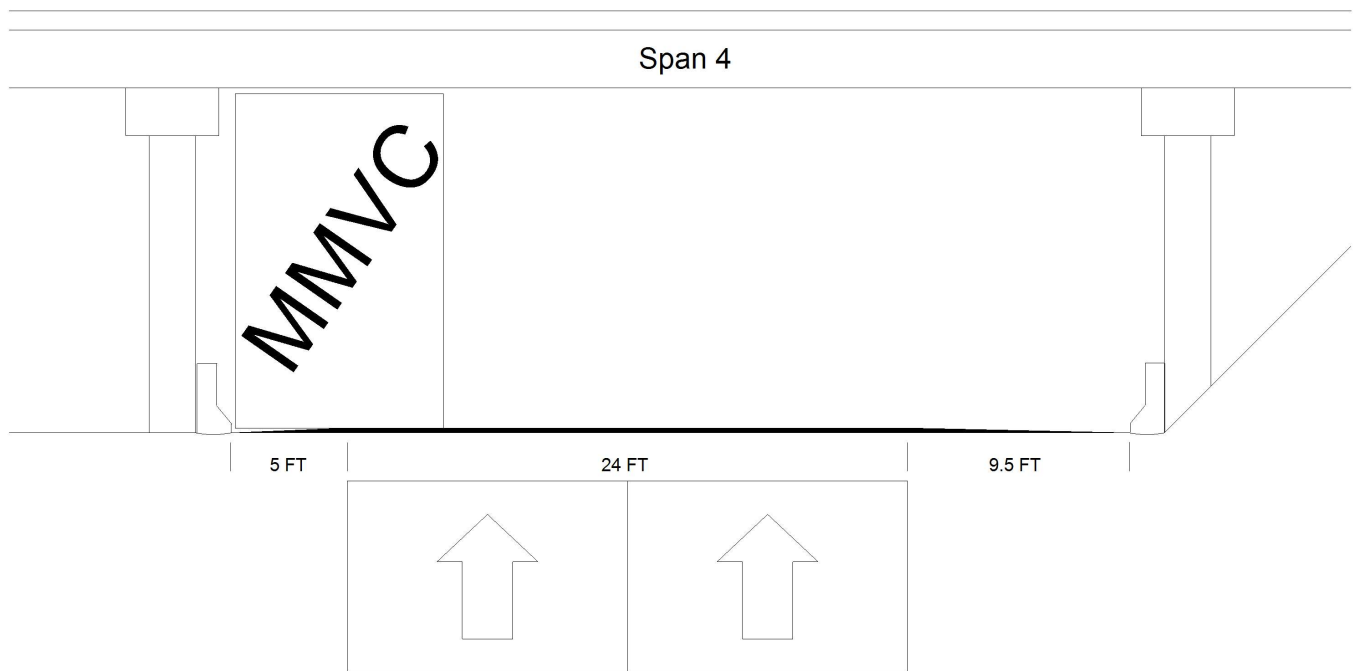

| | | | |
|--------------------------------|--|------------------------|-------|
| Roadway 1 | | Direction of Traffic | North |
| Distance to Left Rail | 5FT | Distance to Right Rail | 9.5FT |
| Distance to Left Toe of Slope | | Distance to Left Bent | 6.5FT |
| Distance to Right Toe of Slope | 11FT | Distance to Right Bent | 11FT |
| MMVC | 15.33 Ft at Beam 5, MEASURED AT 10 FT FROM LEFT CURB | | |
| MVC | 14.67 Ft at Beam 5, MEASURED AT RIGHT CURB | | |

VERIFIED BY HMS 7/8/2015

| | |
|--|-------------------------------------|
| Title UNDER CLEARANCE SPAN 4 | Description LOOKING NORTH |
|--|-------------------------------------|

| | | | |
|-------------------|---------------|----------------|------------------------|
| Bridge No: 750205 | Drawn By: RCL | Date: 07/24/11 | File Name: S0066000593 |
|-------------------|---------------|----------------|------------------------|

Bridge Inspection Field Sketch

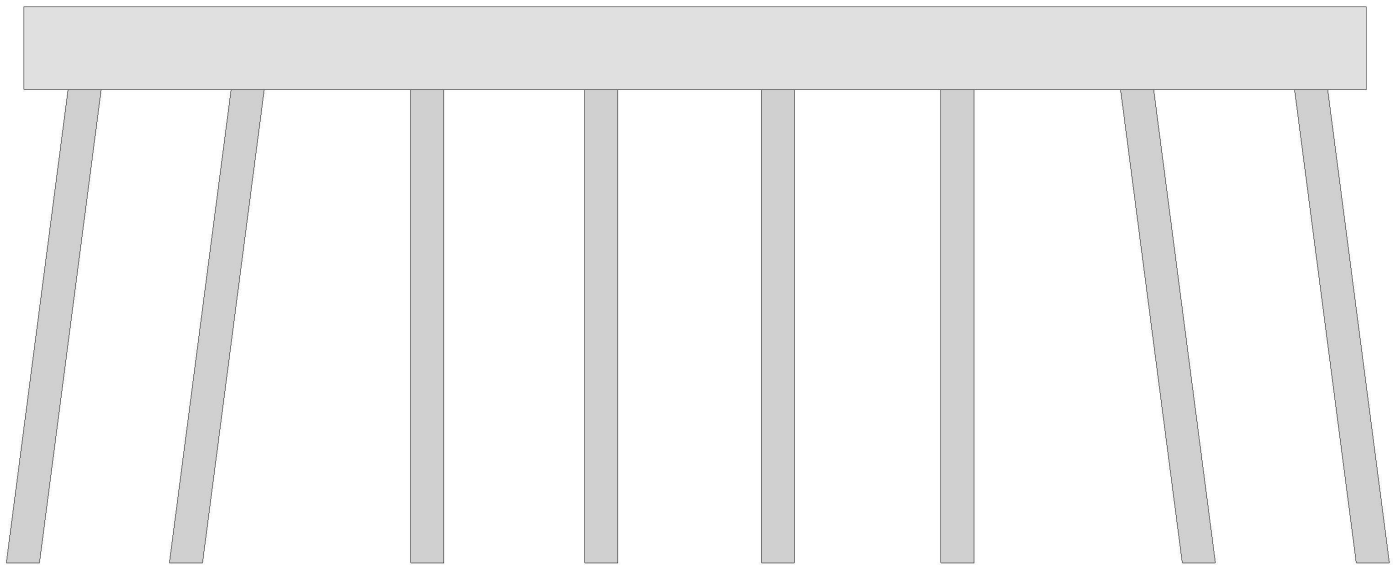

| | | | | | | | | | | |
|---------------------------|-----------------|----------------|---------------------------------|----------------|--------------------------|---------------------------|----------------|---------------------|-----------------|----------------|
| Cap Information | | | Material Cast-in-Place Concrete | | | | | | | |
| Length | Width | Height | Left Overhang | Right Overhang | Left Beam to End of Cap. | Right Beam to End of Cap. | | | | |
| 40.500 ft. | 2.500 ft. | 2.500 ft. | 1.830 ft. | 1.670 ft. | 1.830 ft. | 1.830 ft. | | | | |
| Subcap Information | | | Material | | | | | | | |
| Length | Width | Height | Left Overhang | Right Overhang | Left Pile to Splice. | | | | | |
| Sill Information | | | Material | | | | | | | |
| Length | Width | Height | | | | | | | | |
| Pile # | Material | Spacing | Width/Dia. | Height | Length | Orientation | Driven? | Replacement? | Removed? | Collar? |
| 1 | Concrete | 4.92 ft. | 1 ft. | 1 ft. | | Battered | Yes | No | No | No |
| 2 | Concrete | 5.42 ft. | 1 ft. | 1 ft. | | Battered | Yes | No | No | No |
| 3 | Concrete | 5.25 ft. | 1 ft. | 1 ft. | | Vertical | Yes | No | No | No |
| 4 | Concrete | 5.33 ft. | 1 ft. | 1 ft. | | Vertical | Yes | No | No | No |
| 5 | Concrete | 5.42 ft. | 1 ft. | 1 ft. | | Vertical | Yes | No | No | No |
| 6 | Concrete | 5.42 ft. | 1 ft. | 1 ft. | | Vertical | Yes | No | No | No |
| 7 | Concrete | 5.25 ft. | 1 ft. | 1 ft. | | Battered | Yes | No | No | No |
| 8 | Concrete | | 1 ft. | 1 ft. | | Battered | Yes | No | No | No |
| VERIFIED BY HMS 7/8/2015 | | | | | | | | | | |
| Bent/Abutment #: 1 | | | Similar Bents: | | | | | | | |

| | | | | | | |
|-------------------------------------|----------------------|----------------------|------------------------------------|--|--|--|
| Title PILE DIAGRAM BENT 1 | | | Description LOOKING EAST | | | |
| Bridge No: 750205 | Drawn By: RCL | Date: 7/18/11 | File Name: S0062000380 | | | |

Bridge Inspection Field Sketch

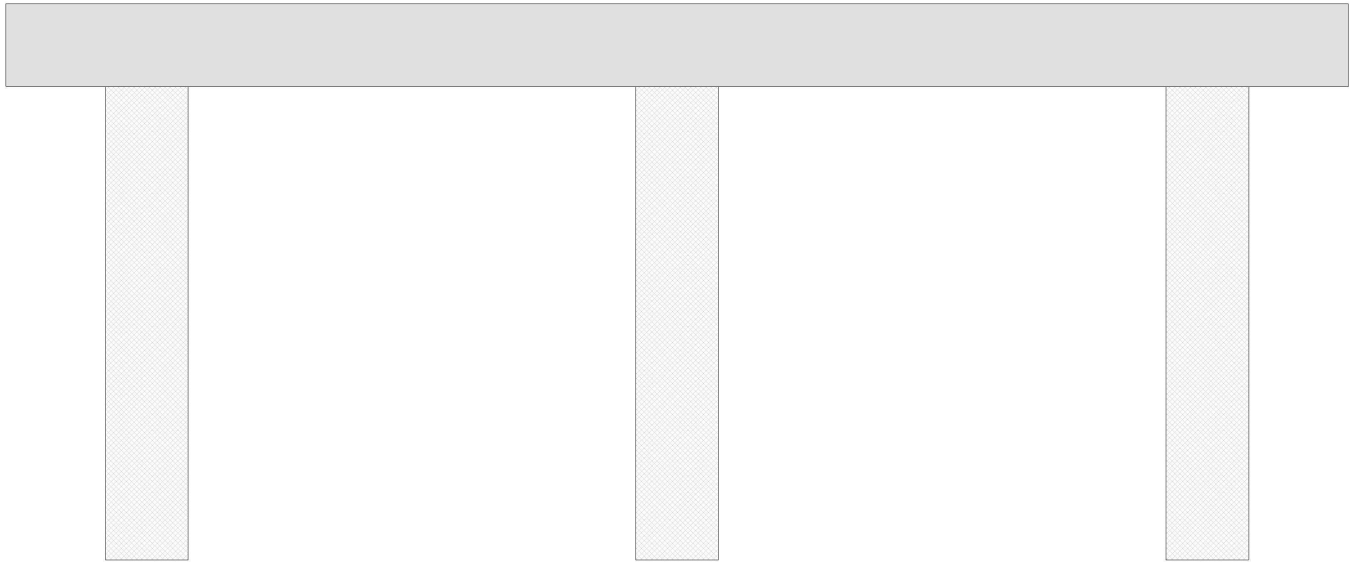

| Cap Information | | | Material Cast-in-Place Concrete | | | | | | | |
|---------------------------|-----------|-----------|--|----------------|--------------------------|---------------------------|---------|--------------|----------|---------|
| Length | Width | Height | Left Overhang | Right Overhang | Left Beam to End of Cap. | Right Beam to End of Cap. | | | | |
| 40.67 ft. | 2.500 ft. | 2.500 ft. | 4.33 ft. | 4.33 ft. | 1.83 ft. | 1.83 ft. | | | | |
| Subcap Information | | | Material | | | | | | | |
| Length | Width | Height | Left Overhang | Right Overhang | Left Pile to Splice. | | | | | |
| | | | | | | | | | | |
| Sill Information | | | Material | | | | | | | |
| Length | Width | Height | | | | | | | | |
| | | | | | | | | | | |
| Pile # | Material | Spacing | Width/Dia. | Height | Length | Orientation | Driven? | Replacement? | Removed? | Collar? |
| 1 | Concrete | | 2.5 ft. | 2.5 ft. | | Vertical | No | No | No | No |
| 2 | Concrete | 16 ft. | 2.5 ft. | 2.5 ft. | | Vertical | No | No | No | No |
| 3 | Concrete | 16 ft. | 2.5 ft. | 2.5 ft. | | Vertical | No | No | No | No |
| VERIFIED BY HMS 7/8/2015 | | | | | | | | | | |
| Bent/Abutment #: 2 | | | Similar Bents: 3,4 | | | | | | | |

| | | | | | | |
|--|----------------------|----------------------|------------------------------------|--|--|--|
| Title PILE DIAGRAM BENTS 2,3,4 | | | Description LOOKING EAST | | | |
| Bridge No: 750205 | Drawn By: RCL | Date: 7/18/11 | File Name: S0062000381 | | | |

Bridge Inspection Field Sketch

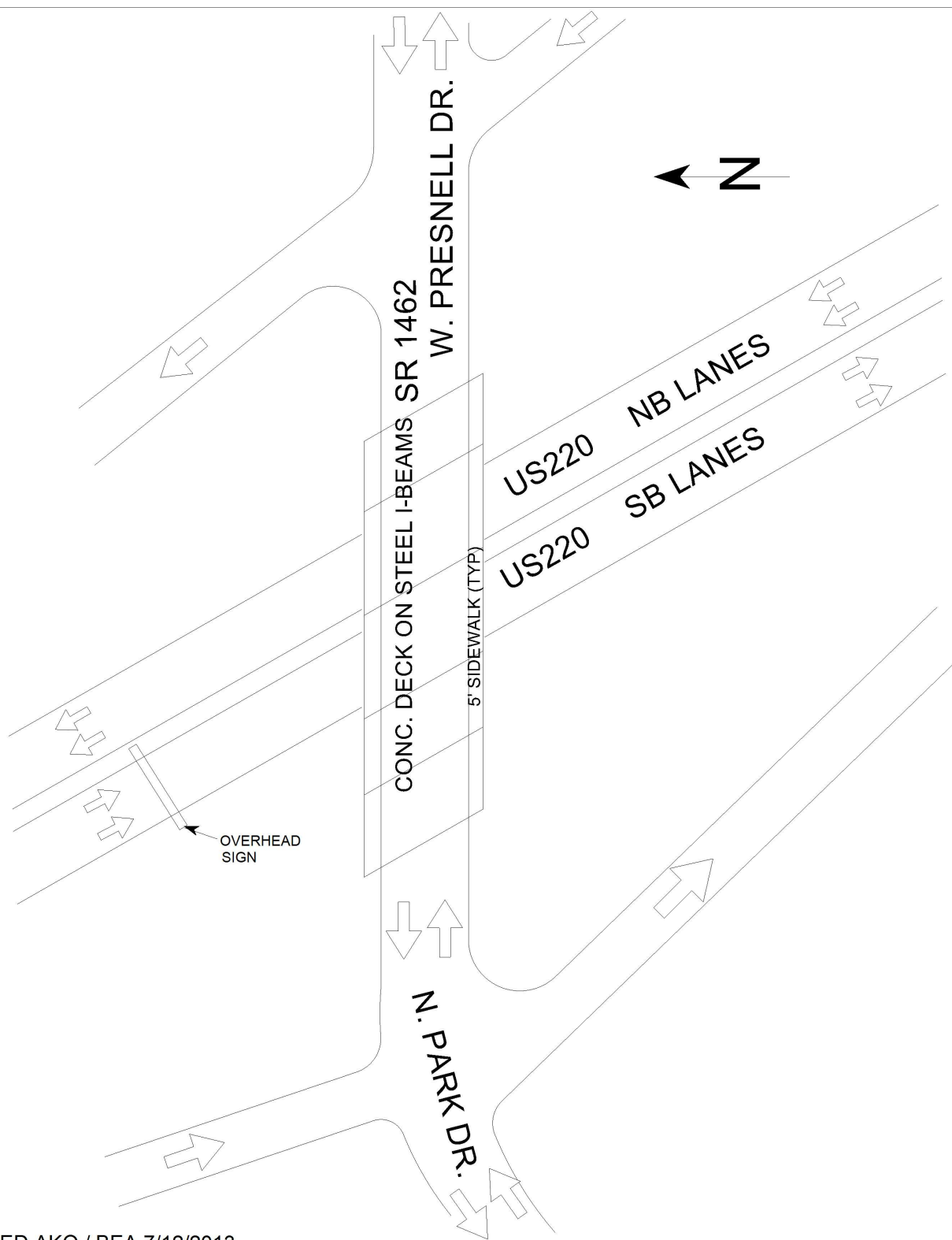

UPDATED AKO / BEA 7/12/2013

| | | | |
|---------------------------------|---------------|---------------------------------|------------------------|
| Title LOCATION SKETCH | | Description PLAN VIEW | |
| Bridge No: 750205 | Drawn By: RCL | Date: 7/25/2011 | File Name: S0350000203 |